

SPIKE LIGHT

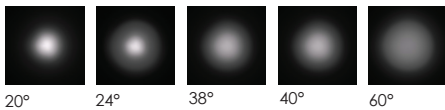

Lens



Product Specifications

Material	Die Cast Aluminium
Light Window	Tempered Glass (T-4~6mm)
Operating temperature	-20°C – 50°C
Power Cable	H05RN-F 2X0.75mm ² 1mtr Cable
Mounting sleeve	U bracket for solid ground, ABS Spike for soft ground
Dimmable Support	Non Dimmable
LED Chip	CREE COB LED
Warranty	3 years against manufacturing defect

Optional Accessories

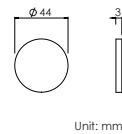

Outer Dimensions

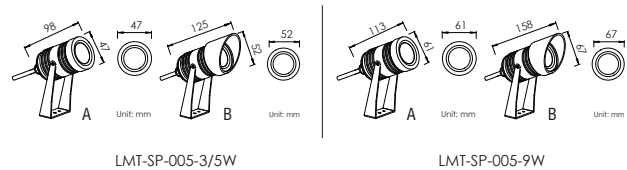

LED Colour Temperature

Finishing

- A 3000K
- B 4000K
- C 5000K

- Anodised Matt Silver
- Black

Model No.	Material	Power (W)	Input voltage(V)	Beam Angle	Typical luminance(lm)	IP Rating
LMT-SP-005-3W	Die Cast Aluminium	3Watts	12V AC	20°/ 40°/60°	250lm	IP67
LMT-SP-005-5W	Die Cast Aluminium	5Watts	12V AC	24°/ 40°/60°	550lm	IP67
LMT-SP-005-9W	Die Cast Aluminium	9Watts	12V AC	20°/ 30°/38°	1050lm	IP67

